

HYPHERPRO

STEERING DAMPER MOUNTING KIT

for

Kawasaki ZX-6R Model '07-'08

MK-KA06-T006 PART LIST

SD stroke 75	1	Bolt M8x35 button head	1
Tube Clamp TYPE 10	1	Bolt M8x70 button head	1
O-Ring	3	Spacer Type 1	2
Fork clamp ϕ 50	1	Washer M6 ϕ 12	5
Fork clamp spacer L30	1	Washer M8 ϕ 16	1
Tank bracket	1	-	-
M6x16 Button head	1	-	-
M6x40	2	-	-

ALL IDEAS, DESIGNS ARRANGEMENTS AND PLANS INDICATED OR REPRESENTED BY THIS DRAWING ARE OWNED BY HYPERPRO AND WERE CREATED, EVOLVED AND DEVELOPED FOR USE ON AND IN CONNECTION WITH THE SPECIFIC PROJECT. NONE SUCH IDEAS, DESIGNS, ARRANGEMENTS OR PLANS SHALL BE USED BY OR DISCLOSED TO ANY PERSON, FIRM OR CORPORATION FOR ANY PURPOSE WHATSOEVER WITHOUT THE WRITTEN PERMISSION OF HYPERPRO.

Damping adjustment knob:
- turn CW to increase damping
- turn CCW to decrease damping
Avoid using maximum setting!

$\pm 1\text{mm}$ clearance

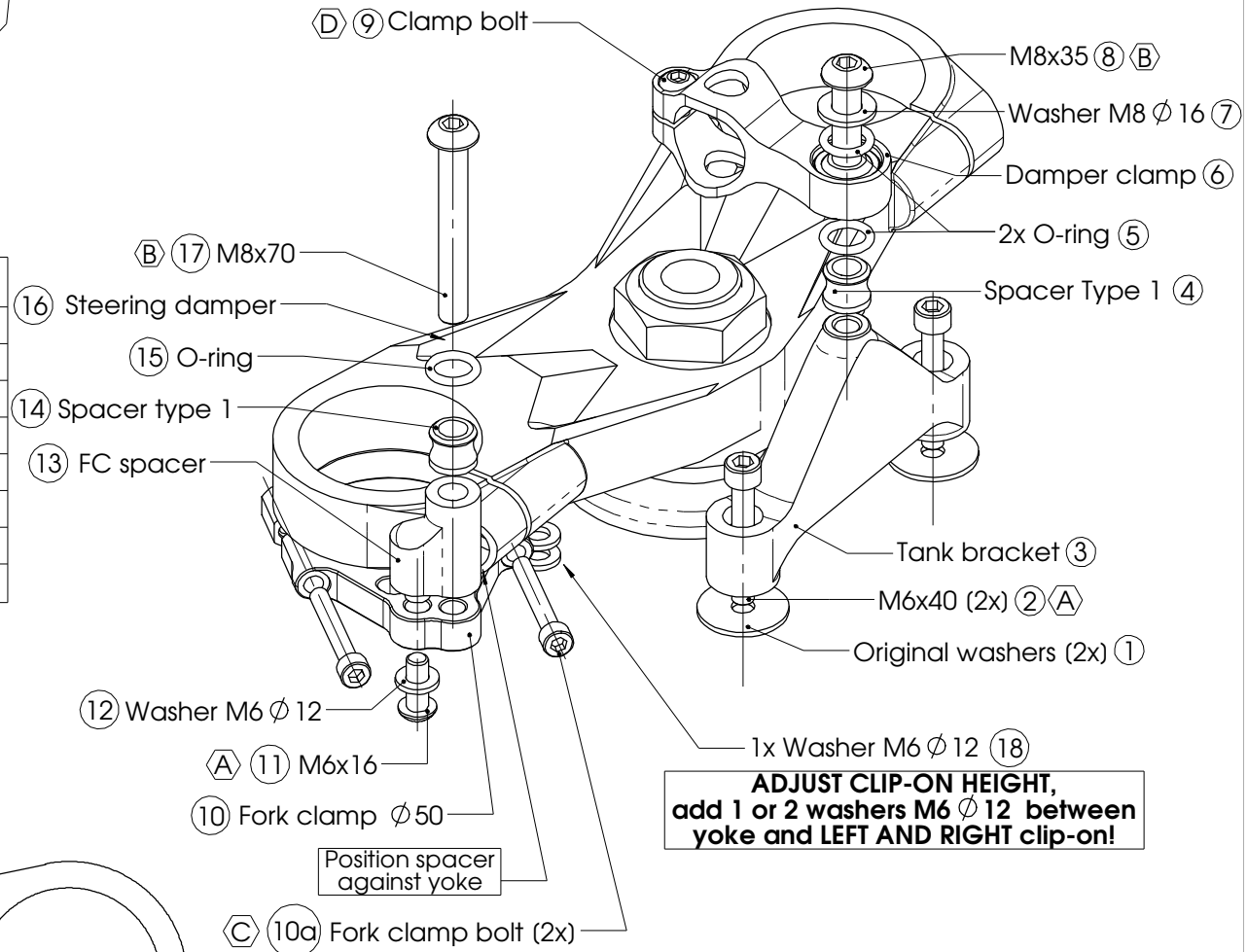
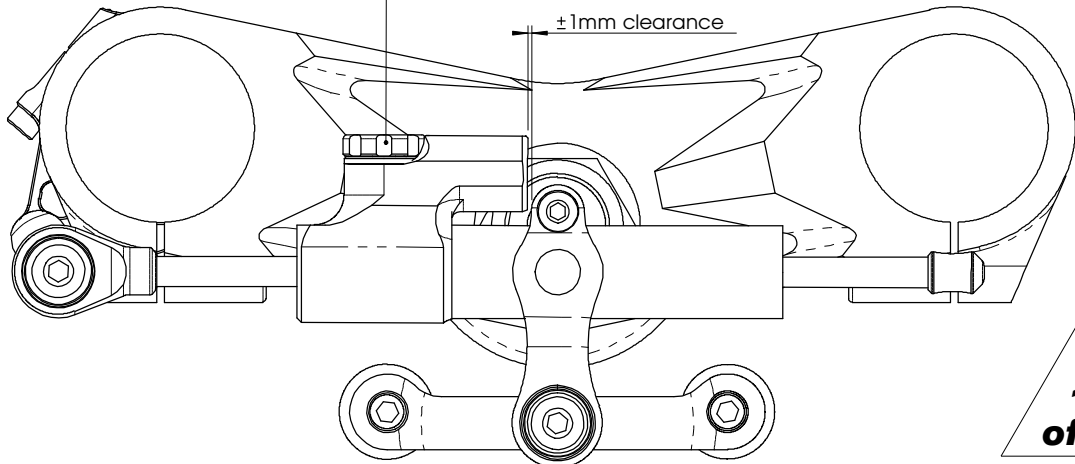

1
of 2

Ⓐ 5-9Nm / 44-80Lbs.In / 4.0-6.4Lbs.Ft

Ⓑ 14-17Nm / 124-150Lbs.In / 10.3-12.5Lbs.Ft

Ⓒ 8Nm / 70Lbs.In / 5.9Lbs.Ft

Ⓓ 6Nm / 53Lbs.In / 4.4Lbs.Ft

HYPERPRO

STEERING DAMPER MOUNTING KIT

for

Kawasaki ZX-6R Model '07-'08

MK-KA06-T006 INSTALLATION INSTRUCTIONS

In general:

HYPERPRO can not be held responsible in any way for any form of physical, material, financial or other damage arising from use, assembly or overhaul of HYPERPRO products. HYPERPRO reserves the right to make changes without prior notice.

This product is ONLY TO BE INSTALLED BY A PROFESSIONAL MECHANIC.

This product is only to be used for the motorcycle brand, model and year stated specifically on top of the pages of this manual.

DO NOT attempt to install this product on motorcycles from any different brand, model and/or year than stated on the pages of this manual.

DO NOT use this kit for cars, boats, jet-skies, snowmobiles, ATV's, aircraft, hovercrafts or any other vehicle and/or purpose.

HYPERPRO steering dampers are FOR RACE USE ONLY, NOT FOR HIGHWAY USE!

Before installation:

- Please read the entire manual carefully before starting the installation!
- Check if you have all the tools required. Good tools are a must.
- Protect your bike at the most important places in and around the work area (e.g. tank, fairing, frame, etc.), with a blanket, towel or similar.

During installation:

- Check all operations and parts carefully before, during and after performing each step.
- Clean all surfaces that are required for fitting parts together or for applying self adhesives or loctite, thoroughly with contact cleaner or another degreaser, unless otherwise stated.
- Be careful not to damage or scratch any part of your bike.
- ALWAYS work relaxed and concentrated!! It is very easy to damage something or make a mistake.

After installation:

- Check and make sure that there is no contact between any part of the steering damper kit and any part of the motorcycle. The kit should not hit anything. Steering movement should not be limited by the steering damper. If the steering movement is limited, adjust the position of the tube in the clamp until steering movement is normal again. Do not forget to tighten the clamp bolt again!
- ALWAYS check the steering movement and feeling before each ride!
- FIRST RIDES: Start with the damper turned fully open (turn adjuster knob fully counter clockwise).
- Start adjusting in between rides with steps of MAX. 2 CLICKS (0.25 TURN) EACH TIME, until the damper is working satisfactory for your riding style.
- NEVER USE MAXIMUM SETTING, ALWAYS OPEN AT LEAST 2 CLICKS (0.25 TURN).

- WARNING ! DAMPER HAS AN ACTIVE / SPEEDSENSITIVE DAMPING SYSTEM;
 - Steering with NORMAL MOVEMENT should be FREE !!
 - Steering with FAST MOVEMENT should be CONTROLLED BY DAMPER !!
- HYPERPRO uses a special seal to reduce friction. The seal uses an oil film to work properly. It is normal that some oil can appear on the pistonrod.
- Damper works with oil: DAMPING CAN BE HARDER AT LOWER TEMPERATURES!

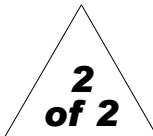

Step 1: installing the tank bracket

Install the tank bracket using:

- 2x Original washers (1) not supplied
- 2x Bolt M6x40 (2)
- Tank bracket (3)

Remove the 2 original M6 bolts and washers from the front tank mounting points.

Install the tank bracket (3), using the 2 supplied M6x40 bolts (2) and the original M6 washers (1) underneath the bracket for support as shown in the right picture on page 1.

Tighten the bolts with a torque of approx. 5-9Nm/44-80Lbs.In/4.0-6.4Lbs.Ft

Step 2: installing the damper clamp

Install the damper clamp using:

- 1x Spacer type 1 (4)
- 2x O-Ring (5)
- Damper clamp type 10 (6)
- Washer M8 \varnothing 16 (7)
- Bolt M8x35 button head (8)

Assemble as shown on page 1: place the parts and (4..8) in the correct order on the tank bracket (3) and tighten the M8 bolt (8) with a torque of approx. 14-17Nm/124-150Lbs.In/10.3-12.5Lbs.Ft.

Step 3: installing fork clamp and steering damper

Install the fork clamp and steering damper using:

- Fork clamp \varnothing 50 (10)
- Bolt M6x16 (11)
- Washer M6 \varnothing 12 (12)
- Fork Clamp Spacer L30 (13)
- 1x Spacer type 1 (14)
- 1x O-ring (15)
- Steering damper, S 75 (16)
- Bolt M8x70 button head (17)
- 2x Washers M6 \varnothing 12 for lowering the Clip-ons (18)

Loosen the left clip-on clamp bolt and the clip-on positioning bolt. Lower the clip-on by adding 1 or 2 washers M6 \varnothing 12 (18) between clip-on and yoke. Retighten the positioning bolt and clamp bolt. Repeat this for the right hand clip-on.

Disassemble the fork clamp (10) and reassemble the parts around the left forkleg, between the top yoke and the clip-on. Make sure that it is oriented correctly as shown in the pictures and temporarily tighten the clamp bolts (10a). Use bolt M6x16 (11) and washer M6 \varnothing 12 (12) to fit FC spacer L30 (13) to the fork clamp. Make sure the main hole is properly aligned and tighten the M6x16 bolt with a torque of approx. 5-9Nm/44-80Lbs.In/4.0-6.4Lbs.Ft.

Rotate the fork clamp (10) so the spacer (13) is touching the yoke and properly tighten the fork clamp bolts (10a) to a torque of approx. 8Nm/70Lbs.In/59Lbs.Ft.
(Do not forget to re-tighten the clip-on bolts if loosened earlier!)

Ensure that the clamp bolt of the damper clamp (6) is pointing forward. Shove the damper (16), with the knob-end first, through the clamp until the ball joint can be fitted to the fork bracket. Use the spacer (14), O-ring (15) and M8 bolt (17) to mount the balljoint to the fork clamp (10). Tighten the bolt with a torque of approx. 14-17Nm/124-150Lbs.In/10.3-12.5Lbs.Ft.

Position the damper tube until the 1mm clearance stated on page 1 is reached, then tighten the damper clamp bolt (9) with a torque of approx. 6Nm/53Lbs.In/4.4Lbs.Ft. Check if the damper is level horizontally and aligned to the bike. Check if the damper does not touch anything (e.g. tank) when steering from left to right. Check if the bike can make it's full steering angle from left to right.

See WWW.HYPERPRO.COM for the latest pictures, modifications, specs, and a drawing of this steering damper kit