

HYPHERPRO

STEERING DAMPER MOUNTING KIT

for

BUELL 1125 R Model 2008>

MK-BU11-C001 PART LIST

SD stroke 75	1	Bolt M6x12	2
Damper Clamp (DB018235)	1	Bolt M8x25 Button head	1
Fork clamp ϕ 55 (FC0550)	2	Bolt M8x30 Button head	1
Frame bracket (FRMK24-1)	1	Bolt M8x80	2
Frame bracket (FRMK24-2)	1	Washer M8 ϕ 16	2
Steering Limiter (FRMK19-2)	2	Zip Tie	2
Spacer D14d8L6 (SP081406)	1	-	-
O-Ring	2	-	-

ALL IDEAS, DESIGNS ARRANGEMENTS AND PLANS INDICATED OR REPRESENTED BY THIS DRAWING ARE OWNED BY HYPERPRO AND WERE CREATED, EVOLVED AND DEVELOPED FOR USE ON AND IN CONNECTION WITH THE SPECIFIC PROJECT. NONE SUCH IDEAS, DESIGNS, ARRANGEMENTS OR PLANS SHALL BE USED BY OR DISCLOSED TO ANY PERSON, FIRM OR CORPORATION FOR ANY PURPOSE WHATSOEVER WITHOUT THE WRITTEN PERMISSION OF HYPERPRO.

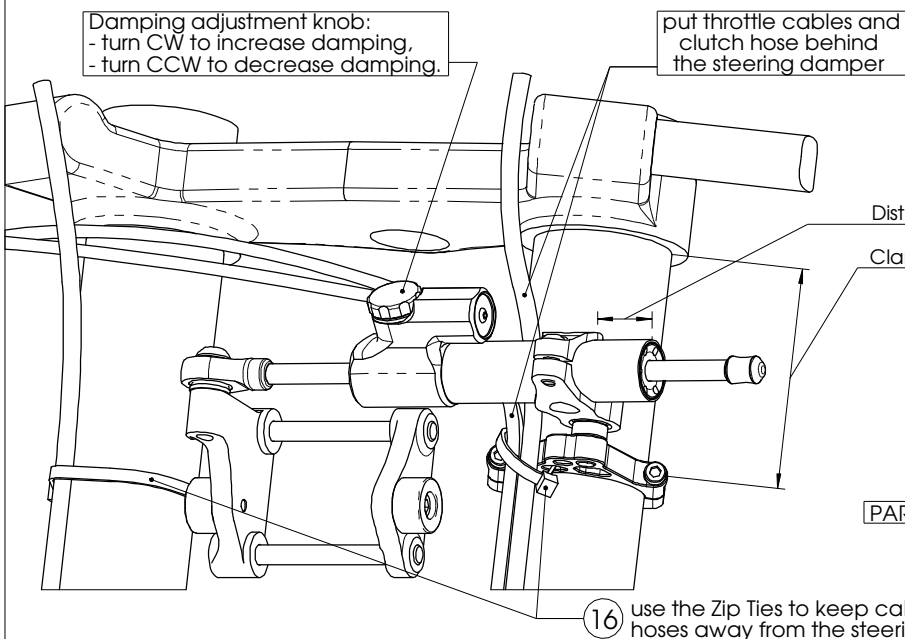

*** This mounting kit limits the max. steering angle to $\pm 25^\circ$ (the steering lock can still be used)**

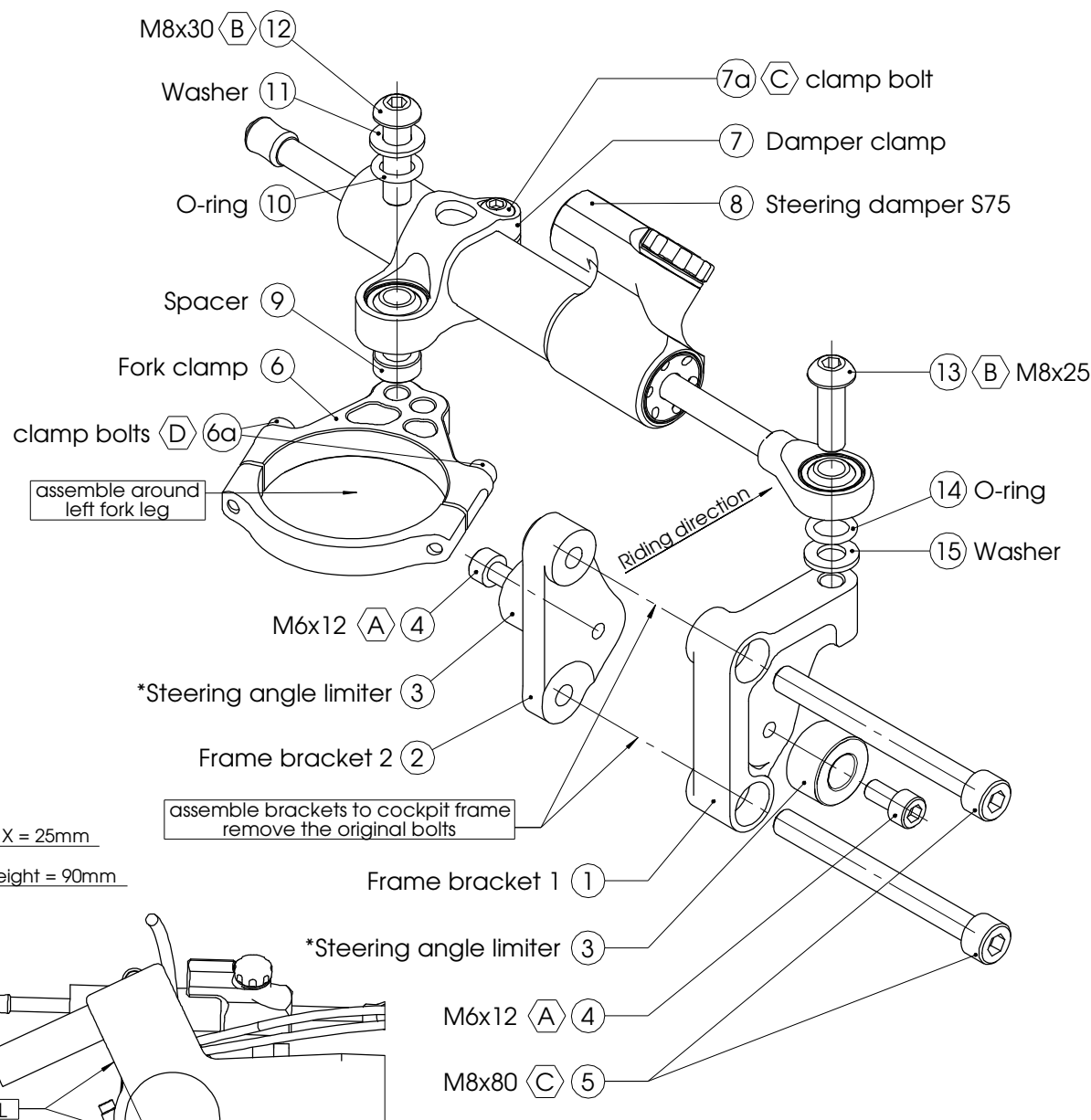

*** TORQUES**

A: 5-9Nm / 44-80Lbs.In / 4.0-6.4Lbs.Ft	E: 55Nm / 486Lbs.In / 40Lbs.Ft
B: 14-17Nm / 124-150Lbs.In / 10.3-12.5Lbs.Ft	F: Factory torque (see owners manual)
C: 6Nm / 53Lbs.In / 4.4Lbs.Ft	

HYPERPRO

STEERING DAMPER MOUNTING KIT

for

**BUELL 1125 R
Model 2008>**

MK-BU11-C001 INSTALLATION INSTRUCTIONS

In general:

HYPERPRO can not be held responsible in any way for any form of physical, material, financial or other damage arising from use, assembly or overhaul of HYPERPRO products. HYPERPRO reserves the right to make changes without prior notice.

This product is ONLY TO BE INSTALLED BY A PROFESSIONAL MECHANIC.

This product is only to be used for the motorcycle brand, model and year stated specifically on top of the pages of this manual.

DO NOT attempt to install this product on motorcycles from any different brand, model and/or year than stated on the pages of this manual.

DO NOT use this kit for cars, boats, jet-skies, snowmobiles, ATV's, aircraft, hovercrafts or any other vehicle and/or purpose.

HYPERPRO steering dampers are FOR RACE USE ONLY, NOT FOR HIGHWAY USE!

Before installation:

- Please read the entire manual carefully before starting the installation!
- Check if you have all the tools required. Good tools are a must.
- Protect your bike at the most important places in and around the work area (e.g. tank, fairing, frame, etc.), with a blanket, towel or similar.

During installation:

- Check all operations and parts carefully before, during and after performing each step.
- Clean all surfaces that are required for fitting parts together or for applying self adhesives or loctite, thoroughly with contact cleaner or another degreaser, unless otherwise stated.
- Be careful not to damage or scratch any part of your bike.
- ALWAYS work relaxed and concentrated!! It is very easy to damage something or make a mistake.

After installation:

- Check and make sure that there is no contact between any part of the steering damper kit and any part of the motorcycle. The kit should not hit anything. Steering movement should not be limited by the steering damper. If the steering movement is limited, adjust the position of the tube in the clamp until steering movement is normal again. Do not forget to tighten the clamp bolt again!
- ALWAYS check the steering movement and feeling before each ride !
- FIRST RIDES: Start with the damper turned fully open (turn adjuster knob fully counter clockwise). Start adjusting in between rides with steps of MAX. 2 CLICKS (0.25 TURN) EACH TIME, until the damper is working satisfactory for your riding style.
- NEVER USE MAXIMUM SETTING, ALWAYS OPEN AT LEAST 2 CLICKS (0.25 TURN).
- WARNING ! DAMPER HAS AN ACTIVE / SPEEDSENSITIVE DAMPING SYSTEM;
 - Steering with NORMAL MOVEMENT should be FREE !!
 - Steering with FAST MOVEMENT should be CONTROLLED BY DAMPER !!
- HYPERPRO uses a special seal to reduce friction. The seal uses an oil film to work properly. It is normal that some oil can appear on the pistonrod.
- Damper works with oil: DAMPING CAN BE HARDER AT LOWER TEMPERATURES!

Step 1: install the frame brackets

Install the frame brackets using:

- Frame bracket 1 (1)
- Frame bracket 2 (2)
- 2x Steering angle limiter (3)
- 2x Bolt M6x12 (4)
- 2x Bolt M8x80 (5)

Support the front cockpit frame and remove the 2 bolts and nuts from the cockpit frame mounting-points (directly in front of the steering head).

Install the frame brackets (1) and (2), using the 2 supplied M8x80 bolts (5), as shown in the pictures on page 1. Tighten with a torque of approx. 14-17Nm/124-150Lbs.In/10.3-12.5Lbs.Ft.

Fit one steering angle limiter (3) to each frame bracket (1 & 2) using a M6 x12 bolt (4). Tighten the bolts with a torque of approx. 5-9Nm/44-80Lbs.In/4.0-6.4Lbs.Fts.

Step 2: install the fork clamp

Install the fork clamp using:

- Fork clamp \varnothing 55 (6)

Remove the clamp bolts (6a) and re-assemble the clamp around the LEFT forkleg. Make sure it is positioned as shown in the pictures (furthest hole outward). Keep 90mm between the clamp and the upper yoke and align the edge of the clamp parallel to the edge of the upper yoke. Tighten the bolts (6a) with a torque of approx. 8Nm/70Lbs.In/5.9Lbs.Ft.

Step 3: install the steering damper and clamp

Install the steering damper using:

- Damper clamp (7)
- Steering damper, stroke 75 (8)
- Spacer (9)
- 2x O-ring (10), (14)
- 2x Washer M8 \varnothing 16 (11), (15)
- Bolt M8x30 button head (12)
- Bolt M8x25 button head (13)

Shove the damper (8) through the clamp (7) as shown in the pictures. Make sure it is correct, then set distance X and tighten the clamp bolt (7a) to a torque of approx. 6Nm/53Lbs.In/4.4Lbs.Ft.

Use the spacer (9), O-ring (10), washer (11) and M8x30 bolt (12) to fit the damper clamp (7) to the fork clamp (6). Make sure the cables and hose are behind the damper and tighten the M8 bolt to a torque of approx. 14-17Nm/124-150Lbs.In/10.3-12.5Lbs.Ft.

Use the O-ring (14), washer (15) and M8x28 bolt (13) to fit the damper ball-joint to the frame-bracket (1). Tighten the M8 bolt to a torque of approx. 14-17Nm/124-150Lbs.In/10.3-12.5Lbs.Ft.

Check if the damper is level horizontally and aligned to the bike. Check if the bike can make its full steering angle from left to right limiter, without being obstructed by cables or other parts of the bike.