

HYPHERPRO

STEERING DAMPER MOUNTING KIT

for

TRIUMPH Speed Triple 1050 Models '05-'07 & '08>

MK-TR10-B001 PART LIST

SD stroke 75 REVERSED	1	-	-
Damper Clamp (DB018235)	1	-	-
O-Ring	3	-	-
Fork Clamp $\varnothing 55$ (FC0055)	1	-	-
Frame Bracket (FRMK22)	1	-	-
M6x35	2	-	-
M8x25 Button head	2	-	-
Washer M8 $\varnothing 16$	2	-	-

ALL IDEAS, DESIGNS, ARRANGEMENTS AND PLANS INDICATED OR REPRESENTED BY THIS DRAWING ARE OWNED BY HYPERPRO AND WERE CREATED, EVOLVED AND DEVELOPED FOR USE ON AND IN CONNECTION WITH THE SPECIFIC PROJECT. NONE SUCH IDEAS, DESIGNS, ARRANGEMENTS OR PLANS SHALL BE USED BY OR DISCLOSED TO ANY PERSON, FIRM OR CORPORATION FOR ANY PURPOSE WHATSOEVER WITHOUT THE WRITTEN PERMISSION OF HYPERPRO.

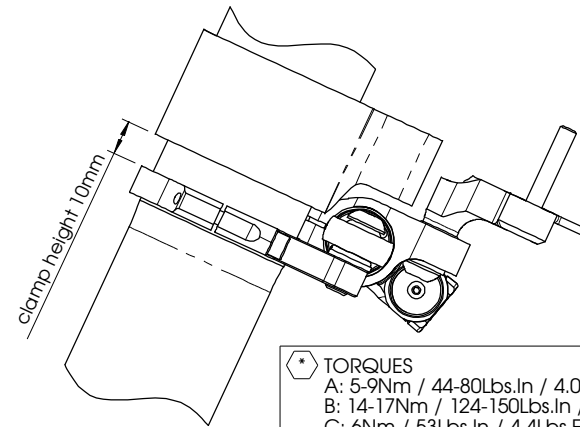
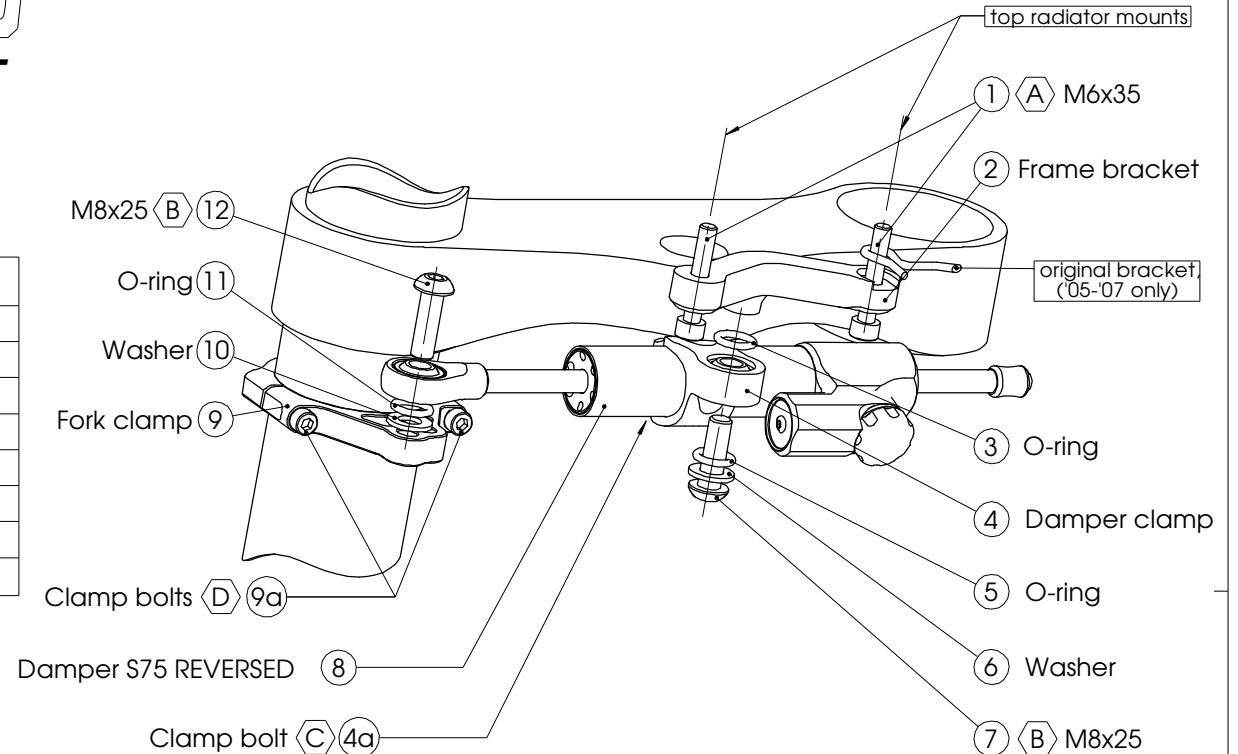
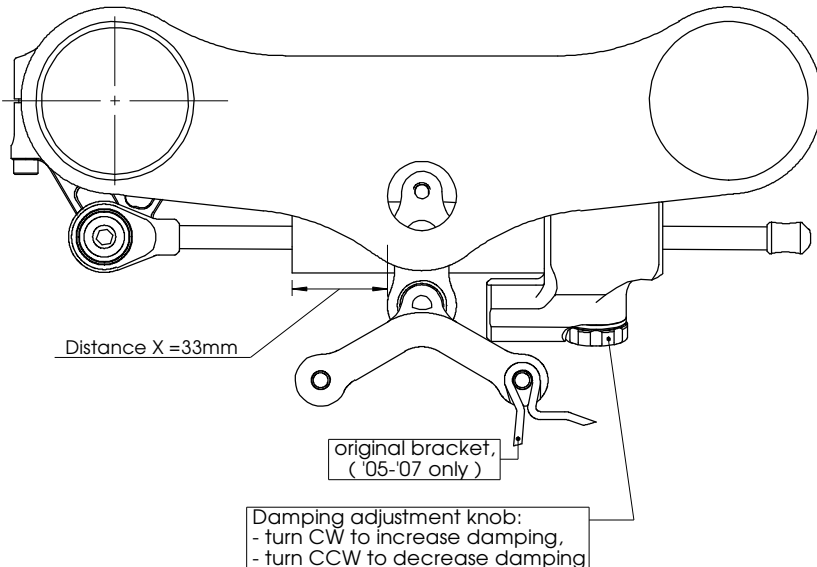

HYPERPRO

STEERING DAMPER MOUNTING KIT

for

TRIUMPH Speed Triple 1050 Models '05-'07 & '08>

MK-TR10-B001 INSTALLATION INSTRUCTIONS

In general:

HYPERPRO can not be held responsible in any way for any form of physical, material, financial or other damage arising from use, assembly or overhaul of HYPERPRO products. HYPERPRO reserves the right to make changes without prior notice.

This product is ONLY TO BE INSTALLED BY A PROFESSIONAL MECHANIC.

This product is only to be used for the motorcycle brand, model and year stated specifically on top of the pages of this manual.

DO NOT attempt to install this product on motorcycles from any different brand, model and/or year than stated on the pages of this manual.

DO NOT use this kit for cars, boats, jet-skies, snowmobiles, ATV's, aircraft, hovercrafts or any other vehicle and/or purpose.

HYPERPRO steering dampers are FOR RACE USE ONLY, NOT FOR HIGHWAY USE!

Before installation:

- Please read the entire manual carefully before starting the installation!
- Check if you have all the tools required. Good tools are a must.
- Protect your bike at the most important places in and around the work area (e.g. tank, fairing, frame, etc.) with a blanket, towel or similar.

During installation:

- Check all operations and parts carefully before, during and after performing each step.
- Clean all surfaces that are required for fitting parts together or for applying self adhesives or loctite, thoroughly with contact cleaner or another degreaser, unless otherwise stated.
- Be careful not to damage or scratch any part of your bike.
- ALWAYS work relaxed and concentrated!! It is very easy to damage something or make a mistake.

After installation:

- Check and make sure that there is no contact between any part of the steering damper kit and any part of the motorcycle. The kit should not hit anything. Steering movement should not be limited by the steering damper. If the steering movement is limited, adjust the position of the tube in the clamp until steering movement is normal again. Do not forget to tighten the clamp bolt again!
- ALWAYS check the steering movement and feeling before each ride!
- FIRST RIDES: Start with the damper turned fully open (turn adjuster knob fully counter clockwise). Start adjusting in between rides with steps of MAX. 2 CLICKS (0.25 TURN) EACH TIME, until the damper is working satisfactory for your riding style.
- NEVER USE MAXIMUM SETTING, ALWAYS OPEN AT LEAST 2 CLICKS (0.25 TURN).
- WARNING ! DAMPER HAS AN ACTIVE / SPEEDSENSITIVE DAMPING SYSTEM;
 - Steering with NORMAL MOVEMENT should be FREE !!
 - Steering with FAST MOVEMENT should be CONTROLLED BY DAMPER !!
- HYPERPRO uses a special seal to reduce friction. The seal uses an oil film to work properly. It is normal that some oil can appear on the pistonrod.
- Damper works with oil: DAMPING CAN BE HARDER AT LOWER TEMPERATURES!

Step 1: install the frame bracket

Install the frame bracket using:

- 2x Bolt M6x35 (1)
- Frame bracket (2)

Remove the 2 original M6x30 bolts from the top radiator mounting points. Install the frame bracket (2) (for '05-'07 models also fit the original cable bracket), using the 2 supplied M6x35 bolts (1) as shown in the pictures on page 1.

Tighten the bolts with a torque of approx. 5-9Nm/44-80Lbs.In/4.0-6.4Lbs.Ft

Step 2: install the damper clamp

Install the damper clamp using:

- 2x O-Ring (3, 5)
- Damper Clamp (4)
- Washer M8 \varnothing 16 (6)
- Bolt M8x25 Button head (7)

Put the assembly together as shown on page 1: fit the damper clamp (4), O-rings (3 & 5) and washer (6) to the frame bracket using the M8x25 bolt (7). Tighten the bolt with a torque of approx. 14-17Nm/124-150Lbs.In/10.3-12.5Lbs.Ft.

Step 3: install the fork clamp

- Fork clamp \varnothing 55 (9)

Remove the two M5 clamp bolts (9a) from the fork clamp (9). Re-assemble the clamp around the LEFT fork leg, 10mm below the lower triple clamp. Make sure that the clamp is oriented and positioned correctly the bracket as shown on page 1. Tighten the clamp bolts (9a) evenly with a torque of approx. 8Nm/70Lbs.In/5.9Lbs.Ft

Step 4: installing the steering damper

Install the steering damper using:

- Steering damper, stroke 75 REVERSED (8)
- Washer M8 \varnothing 16 (10)
- 1x O-ring (11)
- Bolt M8x25 button head (12)

Ensure that the clamp bolt of the damper clamp is pointing forward. Shove the damper (8), with the ball-joint side first, through the clamp until the ball joint can be fitted to the fork clamp. Use the washer (10), O-ring (11) and M8 bolt (12) to mount the ball-joint to the clamp's outer hole and tighten with a torque of approx. 14-17Nm/124-150Lbs.In/10.3-12.5Lbs.Ft. Position the damper tube until the distance "X" stated on page 1 is reached, set the angle and then tighten the damper clamp bolt (9a) with a torque of approx. 6Nm/53Lbs.In/4.4Lbs.Ft. Check if the damper is level horizontally and aligned to the bike. Check if the damper does not touch anything (e.g. tank) when steering from left to right. Check if the bike can make it's full steering angle from left to right.