

REPLACEMENT PARTS

The following replacement part kits are available through a Cannondale Dealer:

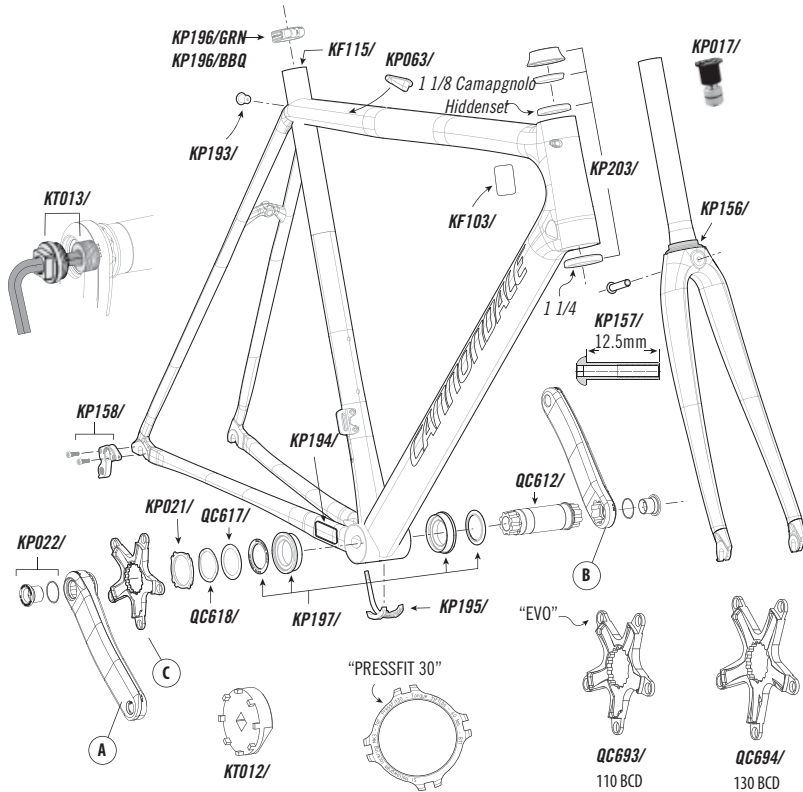

| NO. (QTY) | KIT | DESCRIPTION |
|-----------|------------------|------------------------------------|
| | KP203/ | KIT,HEADSET,SUPERSIX EVO.CRB |
| | KP017/ | KIT,COMP ASSY,23.6ID,EXPANDER |
| | KP156/ | KIT,CROWN RACE, CAAD10/EVO |
| | KP063/ | KIT,GUIDE,BRAKE SUPERSIX EVO 48-50 |
| | KP193/ | KIT,GUIDE,BRAKE SUPERSIX EVO 52-63 |
| | KP157/ | KIT,BRAKE BOLT,12.5MM |
| | KP194/ | KIT,CH.STAY PROTECT-SUPERSIX EVO |
| | KP195/ | KIT,BB CABLEGUIDE, SUPERSIX EVO |
| | KP158/ | KIT,DER HANGER,RD CAAD10/EVO |
| | KF055/ | KIT,ADJUSTER-INLINE SHIFTER-2 |
| | KP196/GRN | KIT,SEATBINDER, ROAD 30.0 |
| | KP196/BBQ | KIT,SEATBINDER, ROAD 30.0 |
| | KP197/ | KIT,BB,PRESSFIT 30, 68/73MM |
| | KF115/ | KIT,GEL,DYNAMIC,CARBN SEATPOST |

| NO. (QTY) | KIT | DESCRIPTION |
|-----------|-------------------|------------------------------------|
| A | KP020/170L | KIT,CRANKARM-SL BLK,170 LFT |
| | KP020/172L | KIT,CRANKARM-SL BLK,172 LFT |
| | KP020/175L | KIT,CRANKARM-SL BLK,175 LFT |
| B | KP020/170R | KIT,CRANKARM-SL BLK,170 RHT |
| | KP020/172R | KIT,CRANKARM-SL BLK,172 RHT |
| | KP020/175R | KIT,CRANKARM-SL BLK,175 RHT |
| C | QC693/ | KIT,SPIDER,H-GRAM SL,110MM BCD |
| | QC694/ | KIT,SPIDER,H-GRAM SL,130MM BCD |
| | KP021/ | KIT,LOCKRING-SL --REQUIRES KT012/ |
| | KT013/ | KIT,TOOL-CRANK EXTRACT - SI |
| | QC617/ | KIT, SHIMS-PLASTIC, BB-SI; 5 SHIMS |
| | QC618/ | KIT,WASHER-WAVE, BB-SI |
| | KP022/ | KIT,CRANK BOLTS,H-GRAM SL,(2) |
| | QC612/ | KIT,SPINDLE-SI ROAD |

REAR BRAKE ROUTING

Rear brake cable routing is internal.

The rear brake cable enters the top tube via the intergrated cable guide. Rear brake housing fits directly into the fitting without a ferrule.

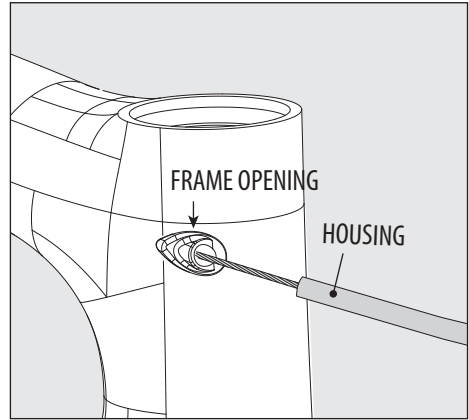

Smaller size frames utilize a top tube opening for the rear brake cable exit. This is necessary due to ensure the right curvature in the cable as it approaches the brake caliper.

The rear top tube brake guide **KP063/** is removable. The guide is secured in the tube opening by the brake cable tension. Make sure the guide is seated properly in the top tube opening when installing and connecting the rear brake. Be sure to use a ferrule on the housing end.

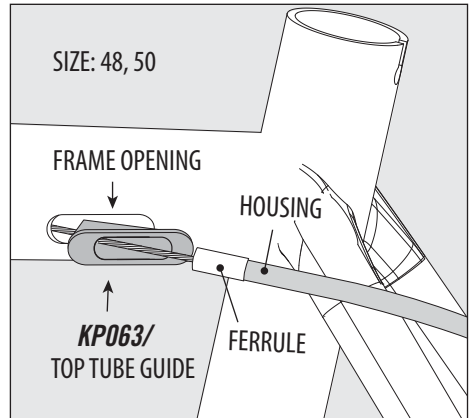

On larger size frames, cable exits at the rear of the seat tube/top tube junction. The rear guide **KP093/** is designed to be used without a housing ferrule as shown. The guide is secured in the tube opening by the brake cable tension.

