

# Trail (2018-2019)

Item	Specification
Head Tube	UPR: 1-1/8 in LWR: 1-1/2 in
Bottom Bracket Type/ Width	BSA 73 mm
Front Derailleur	Direct Mount, Down-Swing
Seat Post Dia./Binder	31.6 mm / 34.9 mm
▲ Min. Seat Post Insert	100 mm
▲ Tire Size x Max. Width	27.5 in x 2.8 in (measured) 29 in x 2.3 in (measured)
▲ Max. Fork Length	530 mm

Item	Specification
Rear Brake: Mount Type / Min/ Max Rotor Dia.	Flat Mount / 160 mm
Rear Axle: Type/Length	QR / 141 x 9 mm, 158 mm
Ai Offset:	N/A
▲ Intended Use	ASTM CONDITION 3, Hardtails.
▲ Max. Weight Limit Total (Rider + all Equipment)	355 lbs / 161 kg

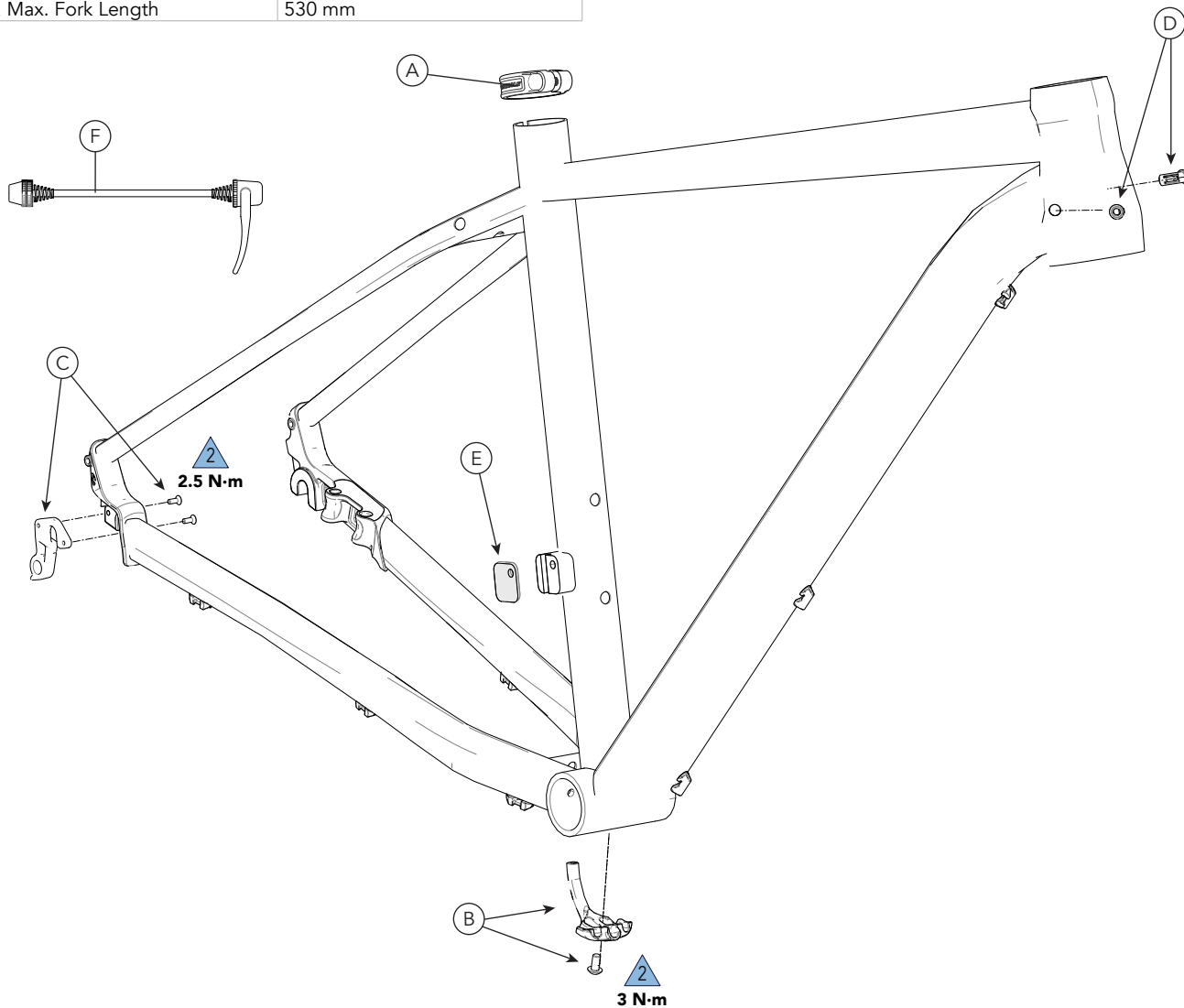

ID	Part Number	Description
A	KP170/BLK	Seatbinder MTN QR 34.9 BLK
B	K32058	Trail Bottom Bracket Cable Guide
C	KP284/	Derailleur Hanger QR ST SS 028
D	K32068	Trail Head Tube Cable Guides

ID	Part Number	Description
E	KP424/	Front Derailleur Mount Cover
F	K83039	QR Skewer 141x9 158 mm