

# AXIAL FANS



# BORAX

## AC AXIAL IN LINE DUCT FAN

BORAX fans are perfect for in-line ventilation applications. Protection grill prevent materials reach to blade, provides safe working.

### Technical Drawings

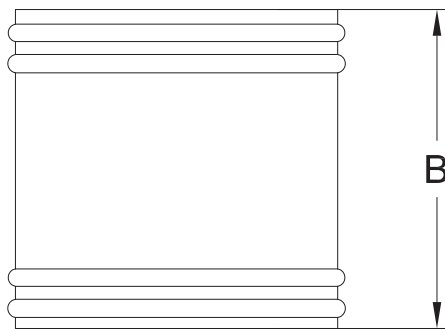
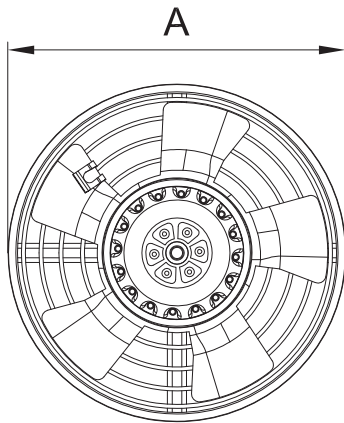

- MATERIAL** : Electrostatic Powder Coated impeller is made of sheet steel.Housing is galvanized sheet steel.
- INSULATION CLASS** : Class B
- DIRECTIVE** : EN 60335-1, EN 60335-2-80
- SPEED CONTROL** : Speed can be adjusted using an optional controller.
- APPLICATION AREAS** : Electrical Panel Cooling ,UPS systems, deep-freezers, cooling welding machines, residential ventilations etc.

### Accessories



**BSC**

TYPE	A	B
BORAX 200-2K	200	200
BORAX 250-2K	250	250
BORAX 300-2K	300	250
BORAX 350-2K	355	250

Dimensions are in (mm)

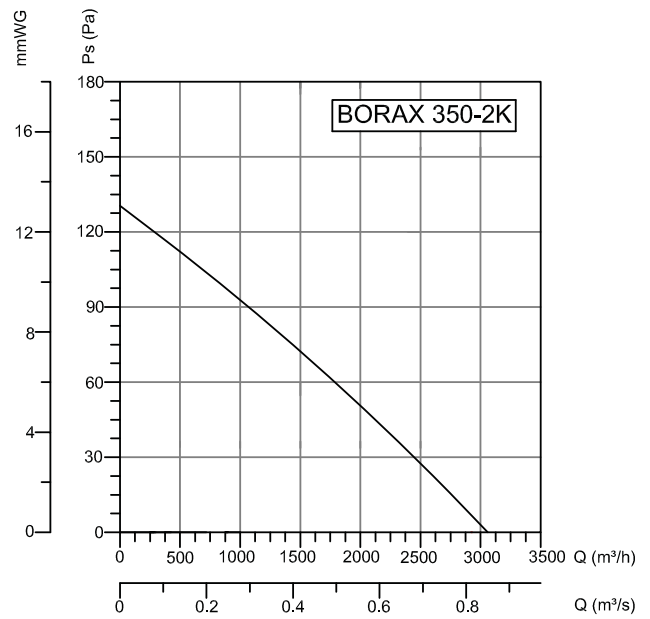
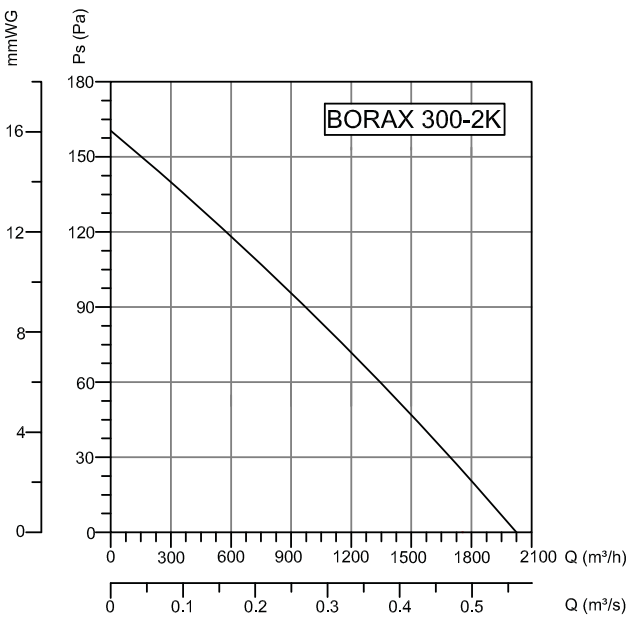
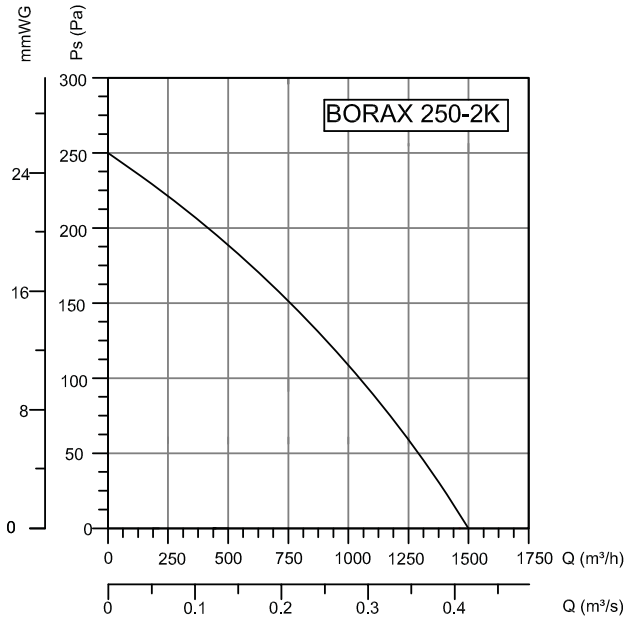
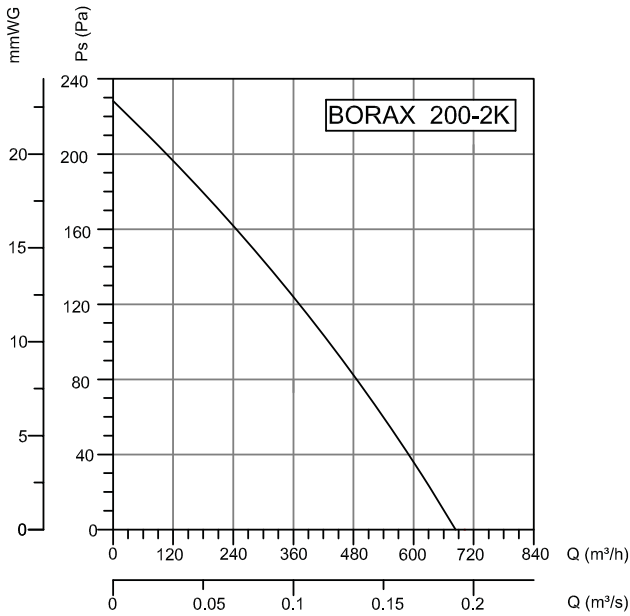

TYPE	VOLTAGE	FREQUENCY	POWER	CURRENT	CAPACITOR	SPEED	AIR FLOW	SOUND PRESSURE LEVEL	WEIGHT
	V	Hz	KW	(A)	(µF)	d/d	m³/h	dB(A)	kg
BORAX 200-2K	230	50	70	0,3	2,5	2650	680	50	2,7
BORAX 250-2K	230	50	100	0,46	4	2700	1500	52	3,6
BORAX 300-2K	230	50	163	0,63	5	2550	2025	54	4,6
BORAX 350-2K	230	50	240	1,1	5	2250	3110	58	5,6